

FARMRY

Your Go-To Source For All Things Tractor
Attachments And Farming Equipment.



Wilshire Boulevard, CA 90017



424-387-6883



farmry.com

GT-X1 NEW PRODUCT LAUNCH

"REVOLUTIONIZE YOUR LAWN CARE : WHERE PRECISION MEETS PERFECTION!"

■ **1.3-METER CUTTING WIDTH EQUIPMENT**

■ **2D LASER**
Short-range obstacle detection

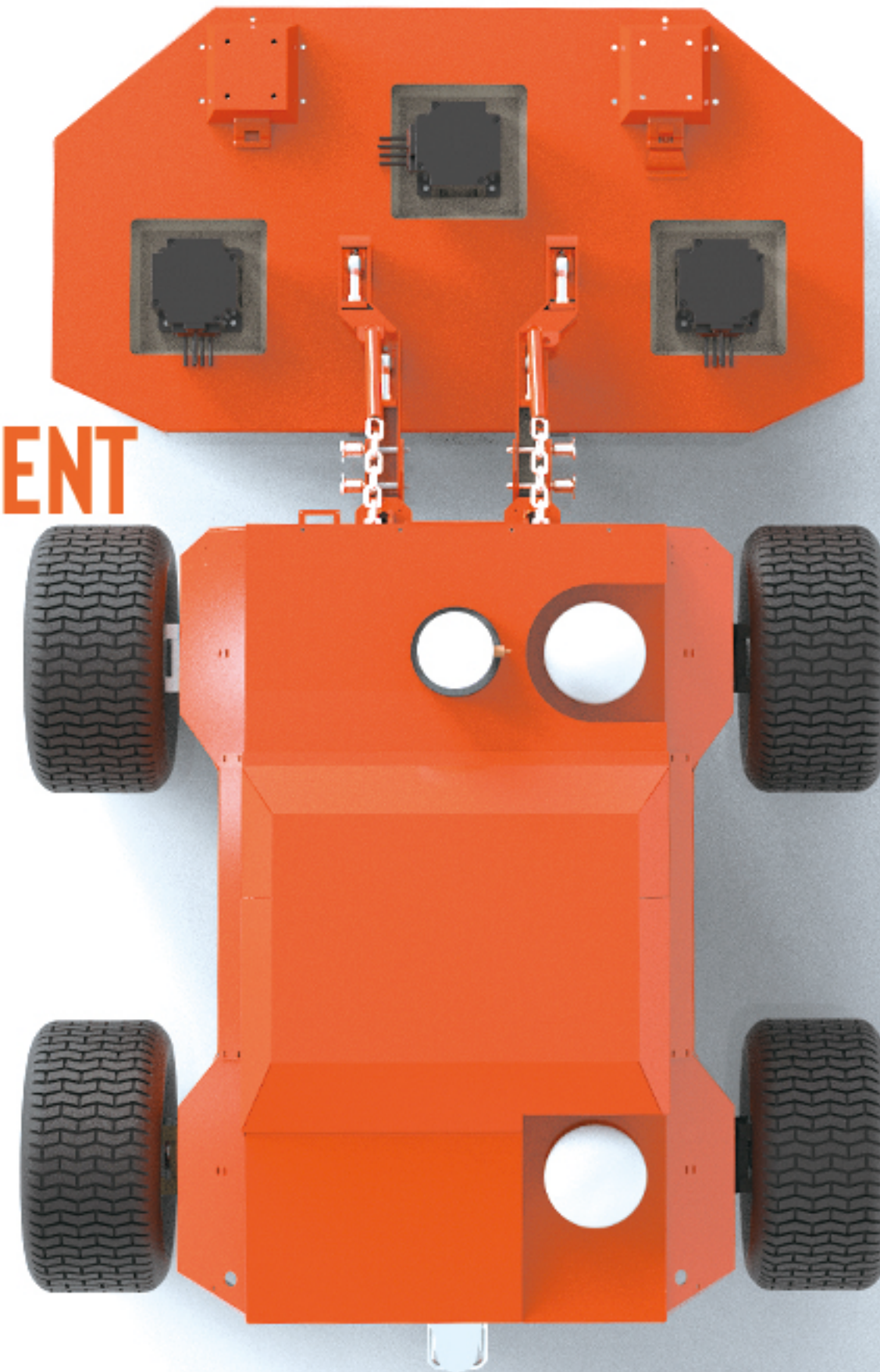

■ **DEPTH CAMERA DETECTS OBSTACLES.**
accurate obstacle identification,
obstacle avoidance

■ **3D LASER**
Long distance obstacle detection and mapping

■ **RTK**
High-precision positioning

PRODUCT GOAL

By offering a Smart AI product to address the issue of customers cutting their own lawns, Accomplishes the dual objectives of freeing labor and operational cost.

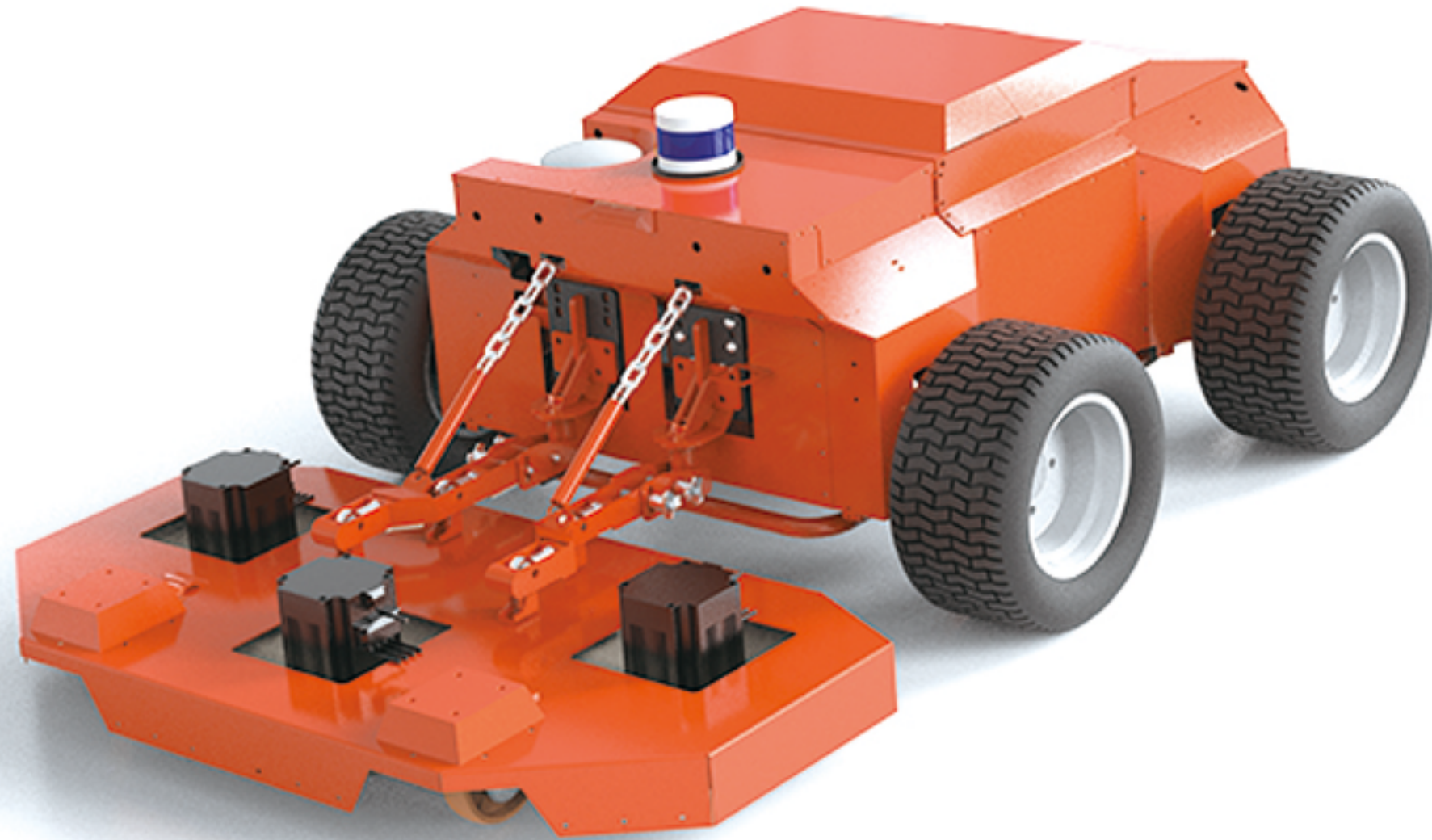

PRODUCT ADVANTAGE



AI POWERED INTELLIGENCE

The product can achieve complete autonomous operation through autonomous planning navigation and obstacle avoidance



VISUALIZATION

You can view real-time job scenarios on the mobile interface



HIGH EFFICIENCY, STRONG ENDURANCE

Large battery, wide operating width



PANORAMIC VIEW

The lower body design can meet the needs of various scenarios.



SECURE

Multiple software and mechanical collision avoidance to ensure safe operation

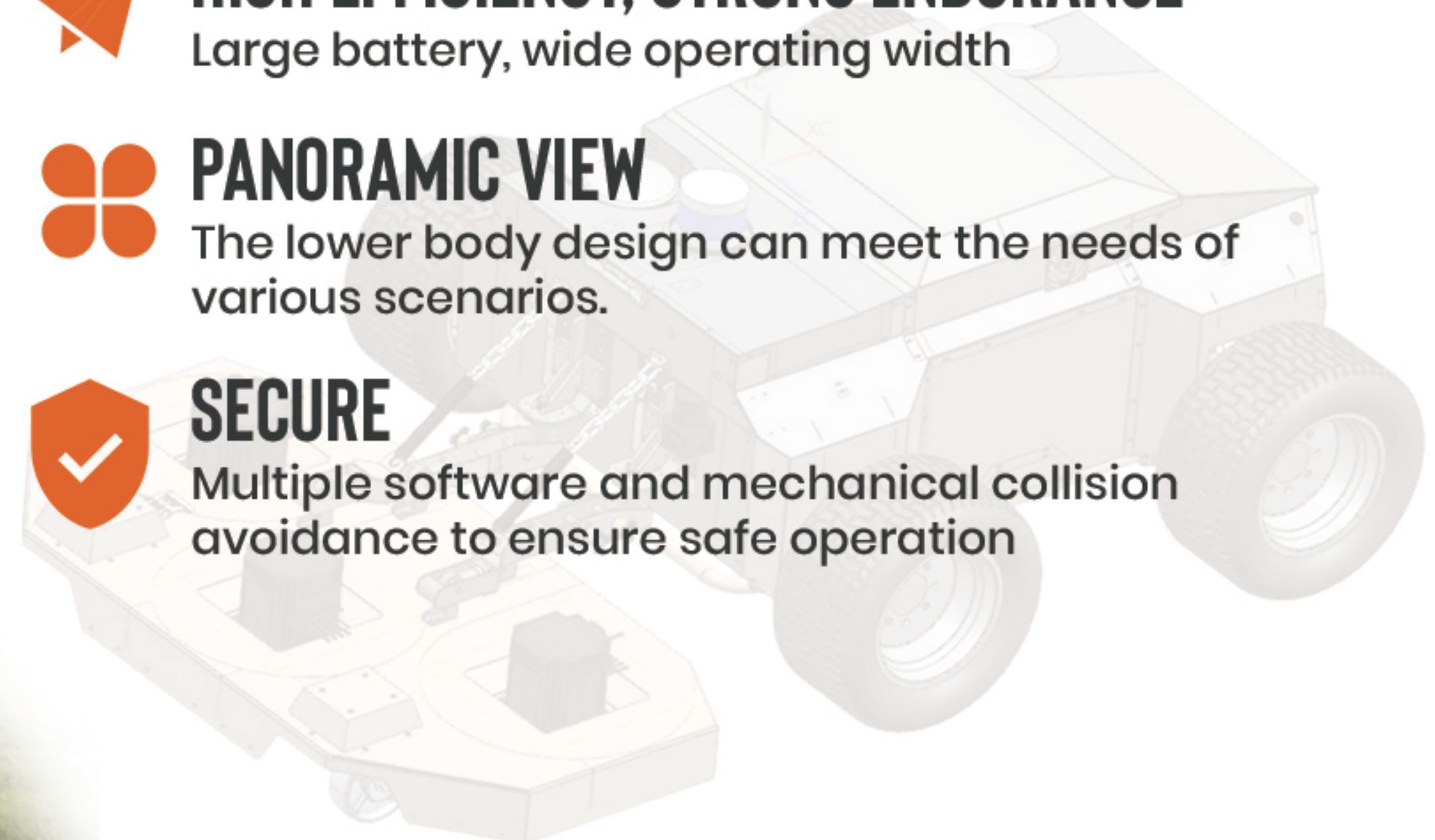

TECHNICAL PARAMETER

Model No.		Model No.	Model No.	Model No.
Length/width/height (mm)		1300*1250*650	Working efficiency (m ² /h)	5000
Working width (mm)		Up to 1200	Tool change time (min)	8
Drive steering	Front wheel	Universal wheel	Single tool life (h)	120
	rear-wheel	Fixed wheel	Maximum mowing width (cm)	125
	swerve	Differential steering	Blade form	Flat knife
	Turning radius	r≈375mm	Blade motor drive mode	Direct drive
Wheelbase (mm)		748	Brake device	Motor braking
Rear wheel base (mm)		1235	Brake device (alternative)	Disc brake
Vehicle equipment mass (KG)		245	Minimum braking distance (m)	2
Travel speed		4.32	Standing slope	Electromagnetic stationary slope
Total power (W)		7500	Minimum ground clearance (mm)	85
System voltage (V)		48	Minimum turning radius (m)	0.375
Operation duration (h)		4	Overstepping barrier	3cm high
Non-mowing work travel time (h)		8	Cross the gully	10cm wide and 3cm deep
Stubble height after operation (cm)		3-7(4)	Down step height	3cm deep
Operating speed (km/h)		0-5	Maximum gradient (%)	22 (+13°)
Job coverage		95%	Maximum downslope (%)	22 (+13°)

WHY CHOOSE

FARMRY?

PREMIUM QUALITY:

Our products, including tractor attachments and farming equipment, are meticulously designed and manufactured to meet the highest standards, ensuring robustness, durability, and long-lasting performance.

EXPERT GUIDANCE:

Our knowledgeable team is always ready to provide expert guidance and assistance, offering valuable insights and technical support to optimize our customers' farming operations.

EXTENSIVE PRODUCT RANGE:

From backhoe loaders to drum mowers, dual directional flail mowers, and rotary hay rakes, we offer a comprehensive selection of the most useful tractor attachments to cater to various agricultural needs.

SUSTAINABLE SOLUTIONS:

We prioritize sustainability in all aspects of our business, promoting eco-friendly practices and contributing to the overall well-being of our planet.



BACKHOE & ACCESSORIES

- Backhoe Loader BH600



MOWERS

- Drum Mower GD Series with Twin Drum Configuration
- PTO Disc Mower 9GXD-280
- RFMax250 Dual Direction Flail Mower



RAKES

- F.HR250 Rotary Hay Rake | 165KG
- Rotary Hay Rake F.HR420 | 590KG



BACKHOE & ACCESSORIES

BACKHOE LOADER BH600



- This robust machine features a heavy-duty digging depth, allowing it to reach impressive depths of 5'10" to 9'2" (depending on the model).
- It boasts compatibility with a broad spectrum of tractors and skid steers, with engine HP ranging from 20 to 100 HP, making it suitable for diverse job sites.

FEATURES:



3-POINT HITCH

Turn your tractor into a backhoe with the simple 3-point hitch mount. The 3-point hitch also utilizes your tractor's drawbar for increased rigidity.



CURVED BOOM

Extended Reach
Greater versatility
Better structural strength

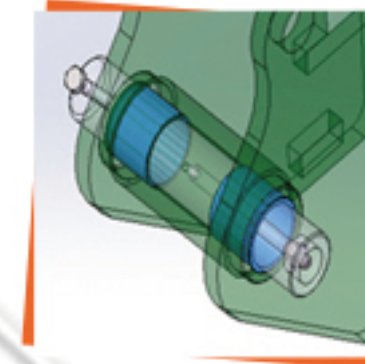

HARDENED STEEL BUSHINGS

To reduce wear, hardened steel bushings are installed on all the main pivot points.

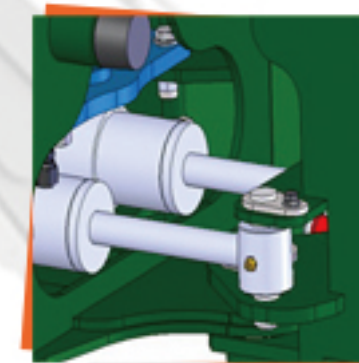

DUAL SWING CYLINDERS

Dual cylinders provide strong, consistent movement throughout the entire 180-degree range.

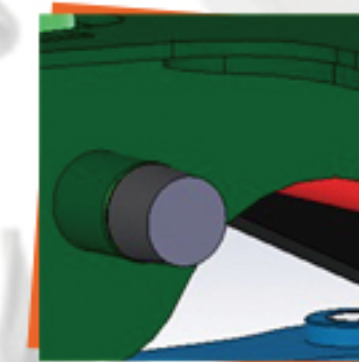

RUBBER PADS BUFFER

When swinging the boom to the extreme ends, rubber pads gracefully bring the boom to a controlled stop.



HYDRAULIC STABILIZERS

Easy to use hydraulic stabilizers to prevent tipping.

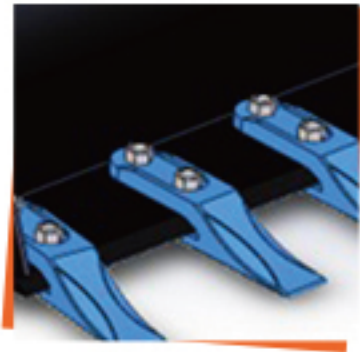

REPLACEABLE TEETH

Allows you to swap out worn or damaged teeth and return to work as soon as possible.



RUBBER FOOTPADS

Keep the stabilizer teeth from tearing up your driveway.



SKID STEERS MOUNT

The universal quick attach plate connects easily to most skid steers.

EXCAVATION RANGE:

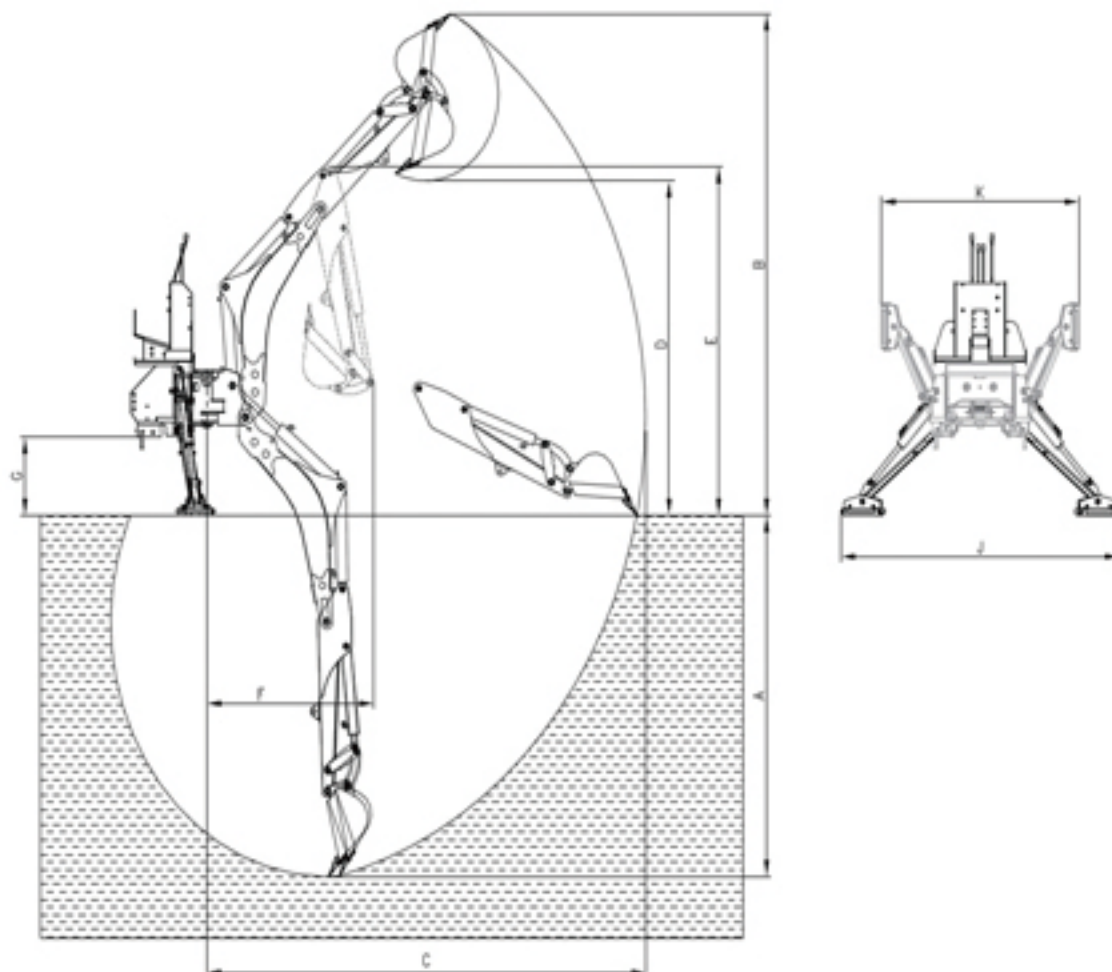

Model No.	BH600	BH700	BH820	BH920
Digging depth (2 ft. flat bottom)	5'10"	6'10"	8'2"	9'2"
Engine HP Range (Tractor)	20-35 HP	20-45 HP	30-65 HP	45-100 HP
Engine HP Range (Skidsteer)	20-50 HP	30-50 HP	30-60 HP	45-100 HP
Required Hydraulic Flow	5-7 GPM			
Stabilizer Width (Spread)	93"			
Main Boom Cylinder Diameter	2.5"	2.8"	2.8"	3.1"
Dipper Cylinder Diameter	2.2"	2.8"	2.8"	2.8"
Bucket Cylinder Diameter	2.2"	2.4"	2.4"	2.4"
Number of Swing Cylinder	2			
Swing Cylinder Diameter	2.4"			
Stabilizer Cylinder Diameter	2.0"	2.0"	2.0"	2.4"
Reach From Swing Post	100"	118"	128"	143"
Flow Divider	Not included	Included		
Bucket Rotation	180°			
Swing Arc	180°			
Dipper Boom Digging Force	1340 lbs	2050 lbs	2120 lbs	2940 lbs
Bucket Digging Force	2730 lbs	3180 lbs	3220 lbs	3635 lbs
Ground Clearance	10.5"			
Loading Height	64"	62"	71"	77"
Overall Operating Height (Fully Raised)	93"	103"	116"	130"
Weight w/bucket (base unit only-no mounts)	710 lbs	880 lbs	940 lbs	1085 lbs
Transport Dimensions (LxWxH)	70"x28"x49"	75"x28"x49"	85"x28"x49"	63"x30"x79"
Operating Pressure	2175 psi	2320 psi	2320 psi	2320 psi
Mounting System	"3-point Hitch CAT.I Skidsteer Mount"		"3-point Hitch CAT.II Skidsteer Mount"	

FARMRY MOWERS

DRUM MOWER GD SERIES WITH TWIN DRUM CONFIGURATION

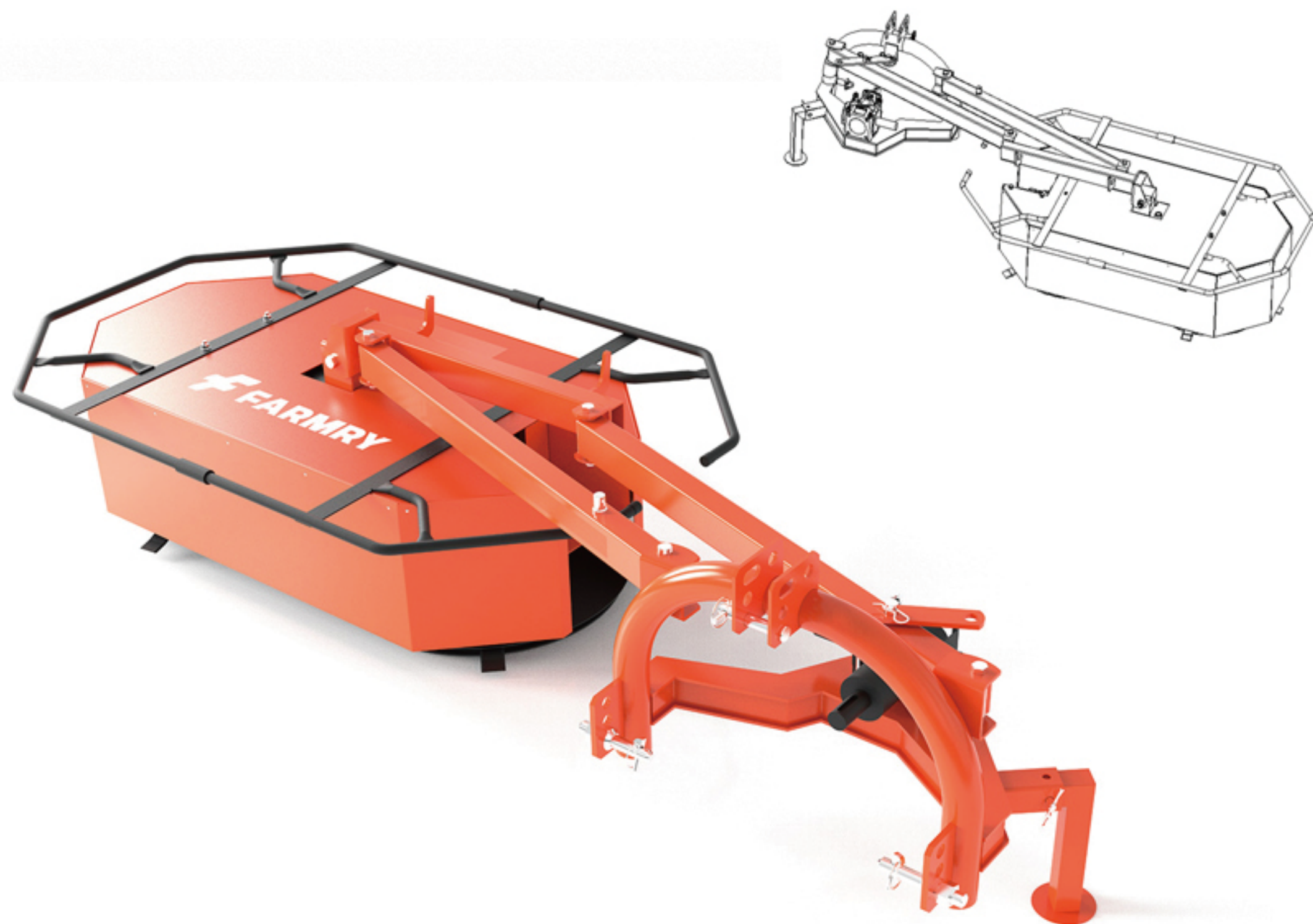

- The GD series is designed to work with tractors with power ranging from 15- 40hp, offering flexibility for different farming operations.
- With high working capacity and adjustable working speeds, it allows you to cover up to 1.35ha/h, providing excellent productivity.
- Its compact transport dimensions make it easy to maneuver and transport, making the Drum Mower GD Series a reliable choice for your grass-cutting needs.

Model No.	G.DM100	G.DM135
Cutting width	1000 mm	1350 mm
Number of drums	2	2
Number of cutting blades	4	8
Tractor power	15-20hp	25-40hp
Length	2185 mm	2505 mm
Width	965 mm	985 mm
Height	665 mm	665 mm
Weight	150 kg	185kg
Working capacity	1ha/h	1.35ha/h
P.T.O Speed	540 r.p.m	540 r.p.m
Working speed	8 - 10 km/h	8 - 10 km/h
Transport dimension	1200*950*575 mm	1450*950*575 mm

PTO DISC MOWER 9GXD-280

- A disc mower utilizes multiple rotating cutting discs to quickly chop up forage or straw.
- With this, you can efficiently harvest various types of forage, such as alfalfa, ryegrass, and oat grass, as well as straw crops like reed.
- From small-scale farms to large agricultural operations, these equipment models provide reliable and efficient solutions for farmers to achieve their productivity goals.

Model No.	9GXD-170	9GXD-210	9GXD-240	9GXD-280
Weight (kg)	490	520	563	610
Cutting width (m)	1.654	2.067	2.414	2.827
Number of discs	4	5	6	7
Number of blades	8 (4L/4R)	10 (4L/6R)	12 (6L/6R)	14 (6L/8R)
Required power (HP)	30-40	30-50	45-55	50-65
PTO speed (r/min)	540	540	540	540
Cutting height (mm)	≤70	≤70	≤70	≤70
Safety mechanism	Standard	Standard	Standard	Standard
Average width of windrow (m)	1.2	1.5	1.8	2.1
Working speed (km/h)	6-10	6-10	6-10	6-10
Attaching method	3-point hitch linkage	3-point hitch linkage	3-point hitch linkage	3-point hitch linkage
Tilting angle	-30°~+90°	-30°~+90°	-30°~+90°	-30°~+90°
Productivity (ha/h)	12	15	18	21



FARMRY MOWERS

PTO DISC MOWER 9GXD-280

- The dual-direction flail mowers are designed and built to provide excellent cutting and shredding performance on gently sloping or slightly contoured grounds, roadsides, ditches, pastures, vineyards, orchards, nurseries, and smaller fields of row crop stalks, and residual agricultural growth.
- You can attach the Flail Mowers to both the front and rear of a tractor.
- This dual-functionality, together with the addition of static counter blades, enables you to efficiently cut grass, weeds, shrubs, and other vegetation regardless of the tractor's direction.



FARMRY RAKES - 165KG

F.HR250 ROTARY HAY RAKE

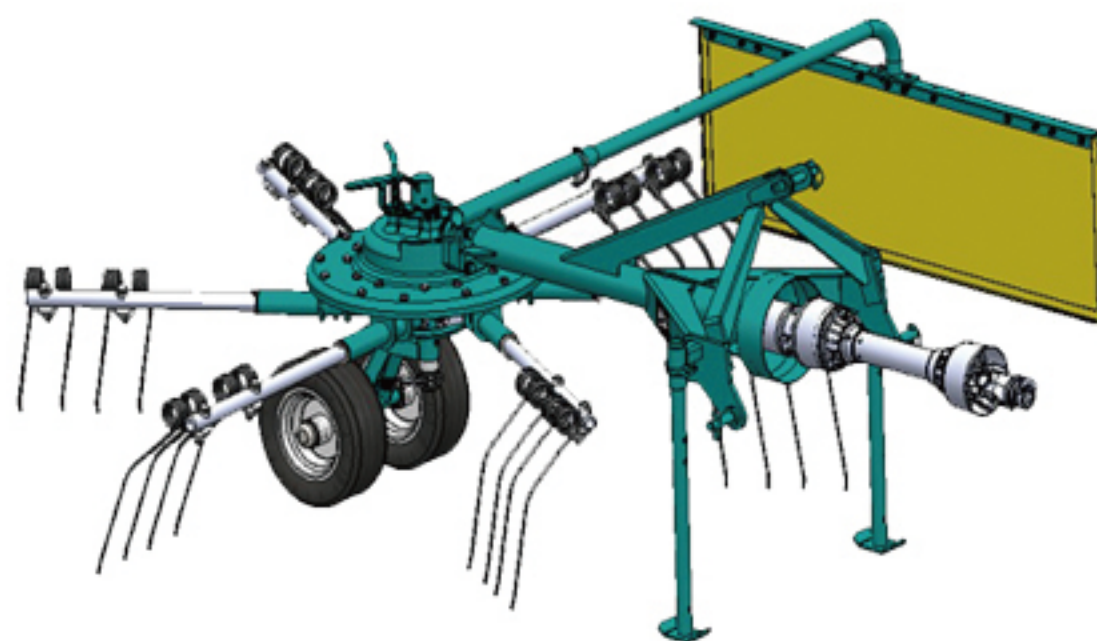
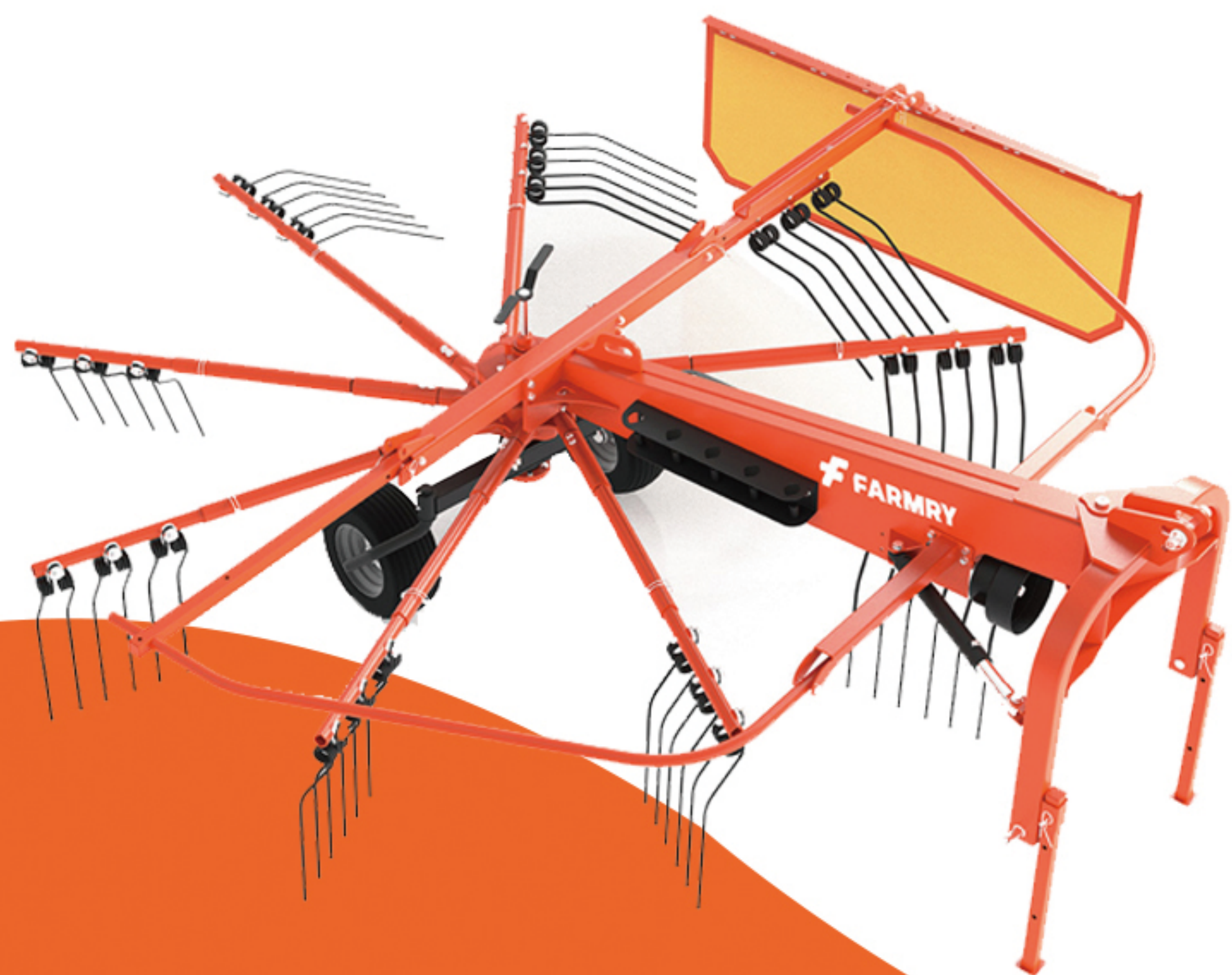

- The F.HR250 Rotary Hay Rake weighs 165kg and boasts a diameter of 195 cm for its rotor disc, ensuring extensive coverage during the harvesting process. With a generous working width of 250 cm, farmers can efficiently collect a significant amount of hay in less time.
- Additionally, the optional tedding feature provides a tedding width of 160 cm, enhancing drying efficiency and improving forage quality.

Model No.	F.HR250
Diameter of rotor disc (cm)	195
Working width (cm)	250
Tedding width (optional tedding feature) (cm)	160
Weight (kg)	165
Number of tine arms	6
Number of tine spring	12
Power requirement (HP)	18-25
PTO speed (r/min)	540
Attaching method	3-point Hitch linkage
Primarily dealing with	Various types of straw and forage

ROTARY HAY RAKE F.HR420 3 - 590KG

Farmry F.HR420, with its 340 cm rotor disc diameter, ensures even wider coverage for optimized productivity. Its impressive working width of 420 cm allows farmers to cover large areas with ease. Weighing 590 kg, this model exhibits robust construction for heavy-duty operations.

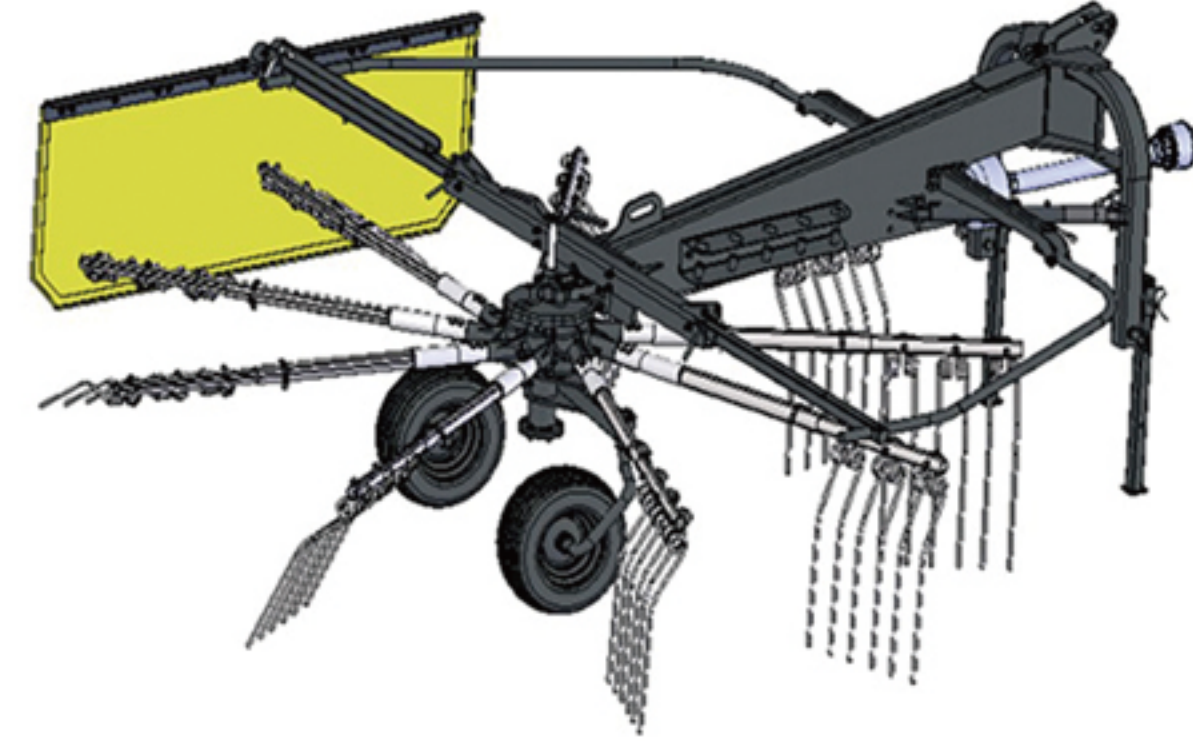

Model No.	G.DM100	G.DM135
Diameter of rotor disc (cm)	1000 mm	1350 mm
Working width (cm)	2	2
Weight (kg)	4	8
Number of tine arms	15-20hp	25-40hp
Number of tine spring	2185 mm	2505 mm
Power requirement (HP)	965 mm	985 mm
PTO speed (r/min)	665 mm	665 mm
Attaching method	150 kg	185kg
Primarily dealing with	1ha/h	1.35ha/h

JOIN US ON THIS FARMING JOURNEY

CONTACT US

Have any questions or inquiries? Feel free to reach out to our friendly team via the Call or Contact Us page. Let's cultivate excellence together with the most useful tractor attachments and farming equipment!



 [linkedin.com/company/95028623](https://www.linkedin.com/company/95028623)

 [facebook.com/profile.php?id=100093529234940](https://www.facebook.com/profile.php?id=100093529234940)

 [instagram.com/farmr.y](https://www.instagram.com/farmr.y)

 twitter.com/FarmryAttach

 www.youtube.com/@Farmry

 medium.com/@farmryattachments

 **Wilshire Boulevard, CA 90017**

 **Info@farmry.com**

 **farmry.com**